

MAINI  
MATERIALS  
MOVEMENT



Value delivered. Always



---

SEMI ELECTRIC STACKERS

---

ELECTRIC STACKERS

---

COUNTER BALANCED STACKERS

---

SIMPLIFYING  
MATERIAL HANDLING  
& WAREHOUSING

# STACKING

# MAINI STACKERS



## Simplifying Material Handling & Warehousing

Maini's range of stackers are designed to enhance productivity, ensure safety and optimize returns. Our comprehensive portfolio has something for everyone, accounting for different space limits, load sizes, floor conditions, operation time and other needs.

Maini's command over innovation, engineering and design is fortified by its commitment to quality and dedicated service. In line with its legacy of innovation, Maini's stackers excel through advanced electronic control, ergonomics & maneuverability. Ensuring enhanced work-flows and boosted productivity, Maini Stackers are a value addition now as well as in the long run.

With Maini in your warehouse, you can rest assured that you can stack your loads just the way you want.

## FEATURES



### TOTAL OPERATOR COMFORT

The new ergonomically designed handle enhances steering comfort



### VISUAL INDICATOR

Beacon is provided as an optional feature for a visibility from long distance to know the presence of the equipment



### CLEAR VISIBILITY

Wide & Robust mast for enhanced and clear visibility

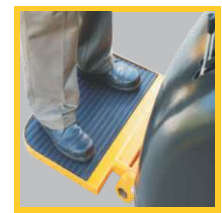

### RIDER COMFORT

Vibration damped stand-on platform which automatically returns to vertical position springs



### CONTROL PANELS

All the controls are easily accessible



### QUICK BATTERY CHANGE

Standard battery rollers for quick and effortless replacement



### EASY MAINTENANCE

Modular drive unit, hydraulics and electronics -easy access for service and maintenance



### MAST TILT

Tilted cylinder allows for safer movement of loads

## ENGINEERING EXCELLENCE

- **Enhanced safety:** Switch which simultaneously cuts-off power supply to motor and actuates parking brake
- **Speed control:** Micro-processor based motor based controller for precise and stepless throttle control
- **Drive unit:** Fully closed oil lubricated gearbox integrated with AC / DC motor
- **Electric system:** Single 24V cross-mounted battery of capacity 330 Ah / C5, 240 Ah / C5, 420 Ah / 5h
- **Hydraulic system:** 2kW pump motor with an integrated reservoir. Steel piping connects hydraulic components. Brake valve is inserted to control lowering speed



Capacity: 1000kg  
Lift height: up to 3100mm

MS10 B

Model : **MS 10B Std/Spl**

Capacity : **1000kg**

Lift height : **Upto 3100mm**

- Light, maneuverable and stable
- Ideal for in-plant operation which require frequent lifting & Lowering of loads
- Lift function is electro hydraulic while movement is manual

### OPTIONS

- Load Platform
- Parking brake
- PU wheels
- Battery Discharge Indicator

## DIMENSIONAL SPECIFICATION : MS-B Series

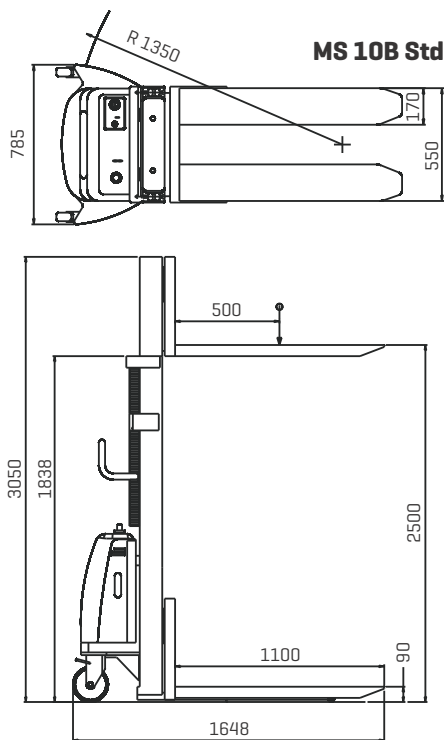

**MS 10B Std**

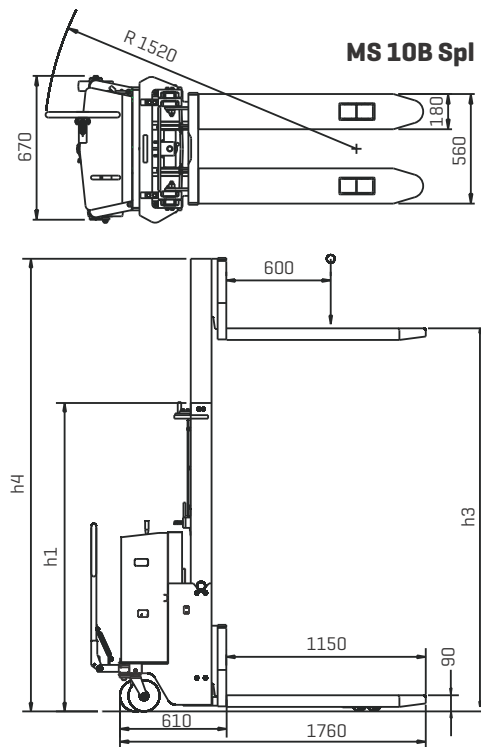

**MS 10B Spl**

All dimensions in mm.

Materials and specifications are subject to change without notice

### WHEELS

Support	Nylon (2)	180 x 50 mm
Load	Nylon (2)	82 x 70 mm

### MODEL - MS 10 B SPL

Lift Height	h 3	2850	3100
Lowered Height	h 1	2080	2180
Raised Height	h 4	3400	3650

# ELECTRIC STACKERS | ST 10i / 12i Series



Model : **ST 10i / 12i**  
 Capacity : **1000/1200 kg**  
 Lift height : **Up to 4200 mm**

- Light duty applications
- Better economy & performance
- Wheel configuration ensures positive traction for firm grip and better stability
- Battery Discharge Indicator with Pump Lock out and Hour Meter

### OPTIONS

- Load Backrest
- Battery Change Trolley

ST10i / ST12i

## DIMENSIONAL SPECIFICATION : ST 10i / 12i Series

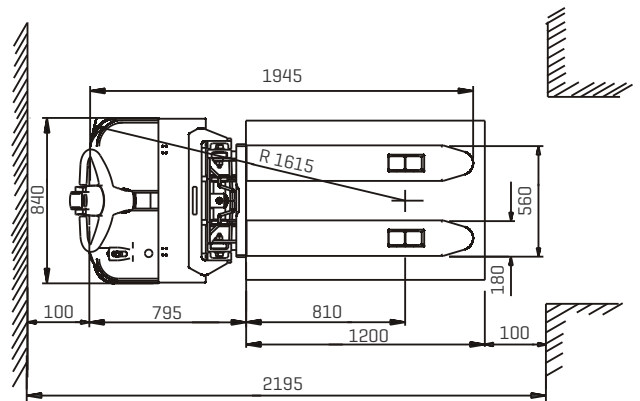
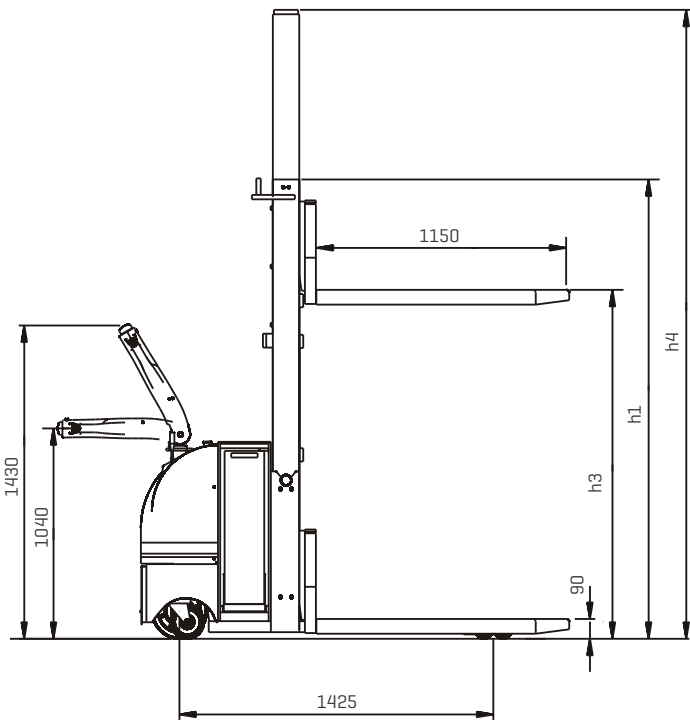

### WHEELS - ALL POLYURETHANE

Drive	[1]	250 X 80 mm
Castors	[2]	150 X 50 mm
Bogie Load	[4]	82 X 70 mm

### MAST PROGRAM

Lift (h3) mm	Height mast lowered (h1) mm	Height mast extended (h4) mm	Capacity at 600 mm L.C. kg	
			ST10i	ST 12i
1580	2035	2035	1000	1200
2000	1600	2530	1000	1200
2450	1780	2965	1000	1200
2850	1980	3365	800	950
3100	2106	3620	700	800
3350	2230	3865	600	700
3600	2400	4100	450	550
4200	2700	4700	350	450

Turning radius = 1615 mm  
 Aisle width = 2195 mm

All dimensions in mm.  
 Materials and specifications are subject to change without notice

### GRADIENT PERFORMANCE

Gradient calculation formula [%] = H/Lx 100

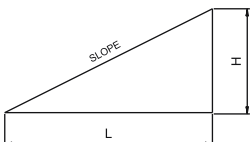

Please refer technical specification chart in the last page for gradeability.  
 Please note with the given gradeability [as mentioned in the chart]  
 the maximum permissible distance on the slope is 13 m



ST15i (Standard)

Capacity: 1500kg  
Lift height: up to 4200mm

Model : **ST 15i**  
Capacity : **1500 kg**  
Lift height : **Upto 6300 mm**

- Versatile stacker, useful in almost all industrial work environment
- Ergonomically designed for enhanced productivity and safety
- Ideal for operation in narrow aisles and busy gangways due to compact design and small turning radius
- Ability to undergo highly intensive stacking and transportation in minimum time
- Battery Discharge Indicator with Pump lockout and Hour Meter

**OPTIONS**

- Load Platform
- Load Backrest
- Battery Change Trolley
- Beacon & Overhead Guard
- Reverse Beeper
- Fork Extensions
- Special Fork Sizes & Special Mast Types



ST15i WC (Wide Chassis)

Capacity: 1500kg  
Lift height: up to 6300mm



ST15i SS

Capacity: 1500kg  
Lift height: up to 4800mm

Capacity: 1500kg  
Lift height: up to 6300mm



ST15i W



ST15i SS FFL

Capacity: 1500kg  
Lift height: up to 6300mm

## DIMENSIONAL SPECIFICATION : ST 15i models

### ST 15i Std

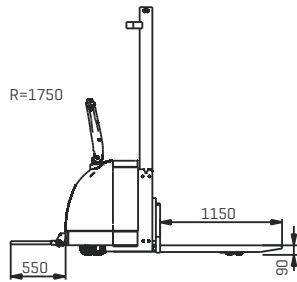
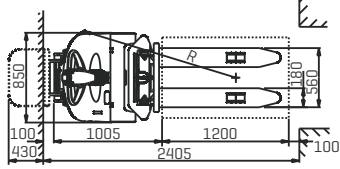

### ST 15i W

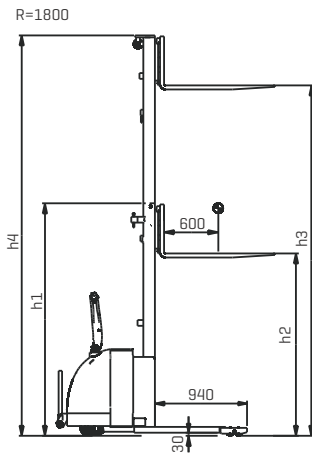
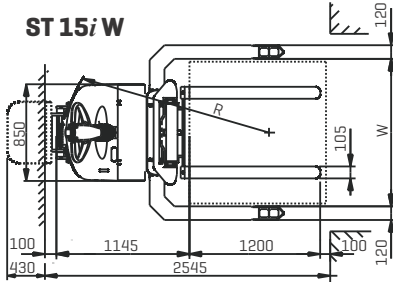

### ST 15i SS

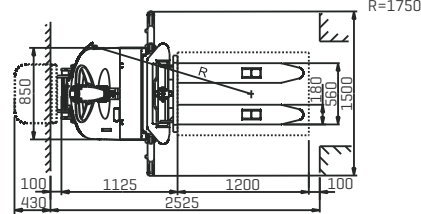

### ST 15i CS

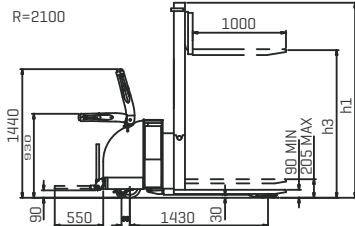
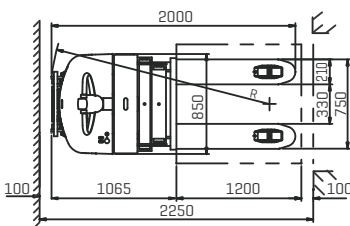

Aisle width = 2900 mm

All dimensions in mm.

Materials and specifications are subject to change without notice

### GRADIENT PERFORMANCE

Gradient calculation formula [%] = H/Lx 100

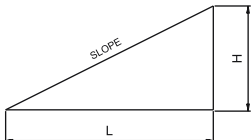

Please refer technical specification chart in the last page for gradeability.

Please note with the given gradeability (as mentioned in the chart) the maximum permissible distance on the slope is 55 m

## WHEELS - ALL POLYURETHANE

Drive	[1]	230 x 75 mm
Castors	[2]	150 x 50 mm
Bogie Load	[4]	82 x 70 mm

## MAST PROGRAM

Lift (h3) mm	Height mast lowered (h1) mm	Height mast extended (h4) mm	Capacity at 600 mm L.C. kg				
			ST 15i	ST 15i W	ST 15i SS	ST 15i CS	ST 15i WC
			1580	2035	NA	1500	1500
1600	2100	2100	-	-	-	2000*	1500
2000	1600	2570	-	-	-	2000*	-
2450	1805	2985	1500	1500	1500	-	1500
2850	2005	3385	1150	1500	1425	-	1400
3100	2130	3635	1050	1500	1375	-	1350
3350	2255	3885	970	1450	1300	-	1275
3600	2380	4135	890	1400	1250	-	1225
3900	2530	4435	800	1350	1180	-	1150
4200	2745	4800	720	1200	1130	-	1100
4500	2900	5105	-	1180	1060	-	1000
4800	3050	5390	-	1050	1000	-	950

## FULL FREE TRIPLE LIFT MASTS

Lift (h3) mm	Height mast lowered (h1) mm	Height mast extended (h4) mm	Free lift (h2) mm	Capacity at 600 mm L.C. kg			
				ST 15i	ST 15i W	ST 15i SS	ST 15i WC
				3600	1825	4125	1300
3900	1925	4425	1400	670	1420	1290	1300
4200	2025	4725	1500	580	1310	1230	1200
4500	2255	5025	1735	-	1240	1170	1100
4800	2355	5325	1835	-	1160	1100	1050
5100	2455	5625	1935	-	1090	1040	1000
5400	2555	5925	2035	-	1010	980	950
5700	2655	6225	2135	-	920	920	800
6000	2755	6525	2235	-	860	850	600
6300	2855	6825	2335	-	550	500	500

Capacities indicated with the battery weight of 285 kg

## FULL FREE LIFT MASTS

[h3]mm	[h1]mm	[h4]mm	[h2]mm	Capacity kg
2850	2005	3385	1520	1150
3100	2130	3635	1650	1050
3350	2255	3885	1780	970

Capacities of W and SS versions remains 1500 kg for the above lifts  
\*1000 Kg per level

# COUNTER BALANCED STACKERS | SC Series



Model : **SC 10 / 14 / 18**  
 Capacity : **1000/1400/1800 kg**  
 Lift height : **Up to 4200 mm**

- Ideal combination of a stacker and forklift
- Features of a sit-down style fork lift without its high costs
- Can handle any type of load
- One vehicle for all operations
- Battery Discharge Indicator with Pump Lockout and Hour Meter

## OPTIONS

- Load Backrest
- Battery Change Trolley

## DIMENSIONAL SPECIFICATION : SC series

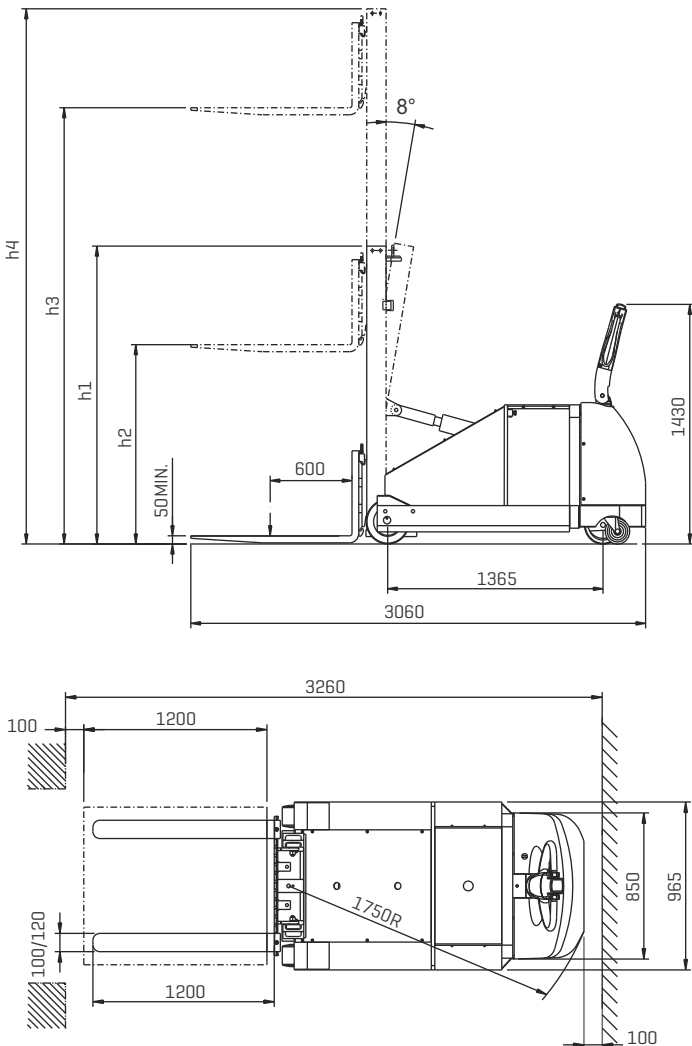

Turning radius = 1750 mm  
 Aisle width = 3260 mm  
 Tilt Angle = 2° Front & 8° Back

All dimensions in mm.  
 Materials and specifications are subject to change without notice

## WHEELS - ALL POLYURETHANE

Drive	[1]	230 x 75 mm
Load	[2]	265 x 125 mm
Support	[2]	150 x 50 mm

## MAST PROGRAM

Lift [h3] mm	Height mast lowered [h1] mm	Height mast extended [h4] mm	Capacity at 600 mm L.C. kg		
			SC10	SC 14	SC 18
1580	2005	NA	1000	1400	1800
			1000	1400	1800
2450	1805	2970	1000	1400	1750
			950	1350	1640
2850	2005	3370	1000	1400	1720
			900	1300	1580
3100	2125	3620	1000	1400	1700
			850	1200	1550
3350	2255	3870	1000	1380	1650
			800	1120	1500
3600	2375	4120	1000	1350	-
			750	1050	-
3900	2525	4420	1000	1320	-
			700	1000	-
4200	2675	4720	1000	1300	-
			600	950	-

Values in red indicate capacity in mast tilt option

## GRADIENT PERFORMANCE

Gradient calculation formula [%] = H/Lx 100

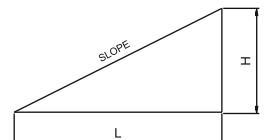

Please refer technical specification chart in the last page for gradeability.  
 Please note with the given gradeability [as mentioned in the chart]  
 the maximum permissible distance on the slope is 17 m



## TECHNICAL SPECIFICATIONS - MAINI STACKERS

Features	Unit	SEMI-ELECTRIC		ELECTRIC								COUNTER BALANCED		
		MS 10B Std	MS 10B Spl	ST 10i	ST 12i	ST 15i	ST 15i W	ST 15i SS	ST 15i/FTL	ST 15i/WC	ST 15i/CS	SC 10	SC 14	SC 18
Capacity	kg	1000	1000	1000	1200	1500	1500	1500	1500	1500	2000	1000	1400	1800
Pump Motor	[V/kW]	12/1.6	24/2.0	24/2.0	24/2.0	24/2.0	24/2.0	24/2.0	24/2.0	24/2.0	24/2.0	24/2.0	24/2.0	24/2.0
Drive Motor	Kw	NA	NA	1	1	1.5	1.5	1.5	1.5	1.5	1.5	1.5	1.5	1.5
Max. Travel Speed	(km/hr)													
Unladen				5.5	5.5	6.5	6.5	6.5	6.5	6.5	7.5	5	5	5
Laden				5.0	4.9	5.5	5.5	5.5	5.5	5.5	5.5	4.5	4.5	4
Gradeability	(%)													
Unladen				10	10	10	10	10	10	10	15	8	8	8
Laden				8	8	8	8	8	8	8	10	4	4	4
Lifting Speeds	(m/s)													
Unladen		0.08	0.15	0.19	0.19	0.14	0.14	0.14	0.11	0.14	0.1	0.1	0.1	0.1
Laden		0.06	0.1	0.11	0.11	0.08	0.08	0.08	0.08	0.08	0.08	0.08	0.08	0.07
Lowering Speeds	(m/s)													
Unladen		0.1	0.13	0.19	0.19	0.17	0.17	0.17	0.18	0.15	0.25	0.11	0.11	0.11
Laden		0.12	0.25	0.15	0.15	0.25	0.25	0.25	0.25	0.25	0.25	0.17	0.17	0.18
Battery capacity	[V, Ah]	12, 60	2 x 12, 60	24,240	24,240	24,345	24,345	24,345	24,345	24,345	24,345	24,420	24,420	24,420
Net Weight	(kg)													
Without battery		260	285	730	770	945	950	995	965	1050	690	NA	NA	NA
With battery		285	310	950	990	1230	1235	1280	1250	1250	975	NA	NA	NA
Wheels		Nylon		Polyurethane								Polyurethane		
Drive	mm	NA	NA	250 x 80	250 x 80	230 x 75	230 x 75	230 x 75	230 x 75	230 x 75	230 x 75	230 x 75	230 x 75	230 x 75
Castors	mm	180x50	180x50	150 x 50	150 x 50	150 x 50	150 x 50	150 x 50	150 x 50	150 x 50	150 x 50	150 x 50	150 x 50	150 x 50
Load	mm	82x70	82x70	82 x 70	82 x 70	82 x 70	82 x 70	82 x 70	82 x 70	82 x 70	82 x 70	265x125	265x125	265x125



### MAINI 360° SOLUTIONS

- Complete range of material handling and storage products
- Custom designed products to address specific user/industry requirements
- Consultation services in intra-logistics space
- Comprehensive after-sales services



To know more about Maini's comprehensive solutions to simplify material handling and warehousing, write to me at [mtrlsmov@maini.com](mailto:mtrlsmov@maini.com)

#### MAINI BRANCH OFFICES

NORTH REGION : Gurgaon  
 SOUTH REGION : Bengaluru, Chennai  
 WEST REGION : Mumbai, Pune, Ahmedabad, Vadodara

#### PAN INDIA CHANNEL PARTNERS

• Ahmedabad • Aurangabad • Bengaluru • Chandigarh • Chennai • Cochin  
 • Coimbatore • Faridabad • Ghaziabad • Goa • Gurgaon • Hosur • Hyderabad  
 • Indore • Jamshedpur • Kanpur • Kolhapur • Kolkata • Madurai • Mumbai  
 • Nagpur • Nashik • Noida • Pune • Satara • Vapi • Visakhapatnam

Visit us at  
[www.mainimaterials.com](http://www.mainimaterials.com)

For enquiries please contact:

**MAINI MATERIALS MOVEMENT PVT. LTD.**  
 Sy. 32, Chandapura, Hosur Road, Bengaluru - 560 099, INDIA.  
 Phone: +91 80 4352 6555 Fax: +91 80 4352 6580