

# MANUAL STACKER | MS10

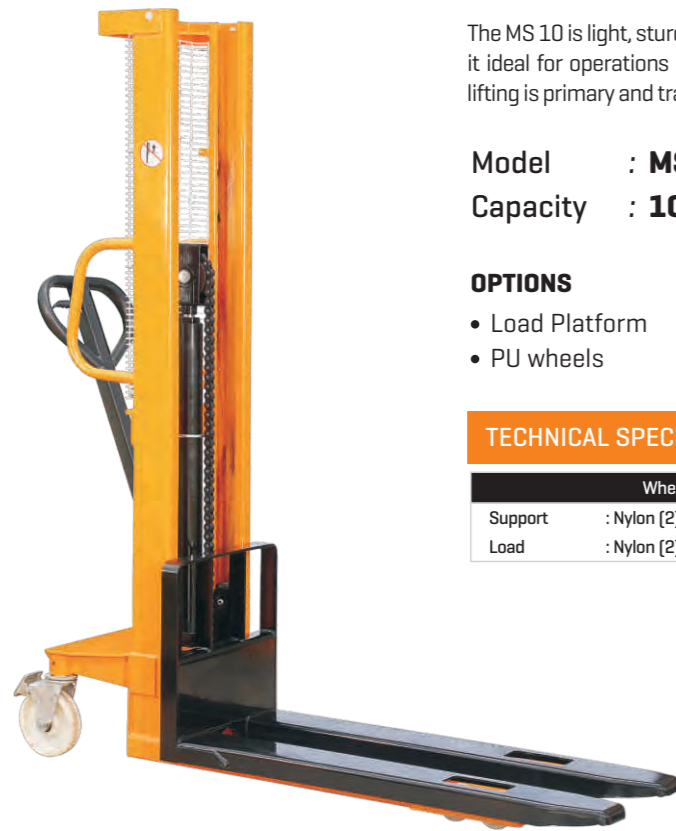

The MS 10 is light, sturdy and maneuverable stacker. Its compact design and small turning radius makes it ideal for operations in narrow aisles, mezzanines and busy gangways. Perfect for operations where lifting is primary and transport distance is short.

**Model : MS10**  
**Capacity : 1000kg**

**OPTIONS**

- Load Platform
- PU wheels

**TECHNICAL SPECIFICATIONS OF MS10**

| Wheels  |             |             |
|---------|-------------|-------------|
| Support | : Nylon (2) | 180 x 50 mm |
| Load    | : Nylon (2) | 82 x 70 mm  |

|                 |          |      |      |
|-----------------|----------|------|------|
| Lift Height     | h 3      | 1600 | 2450 |
| Lowered Height  | h 1      | 2000 | 1780 |
| Raised Height   | h 4      | 2000 | 2920 |
| Fork Dimensions | 1150x560 |      |      |

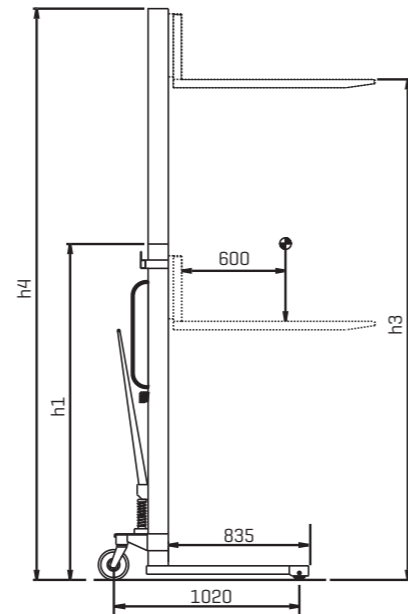
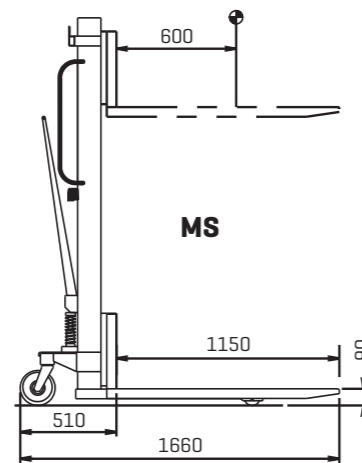
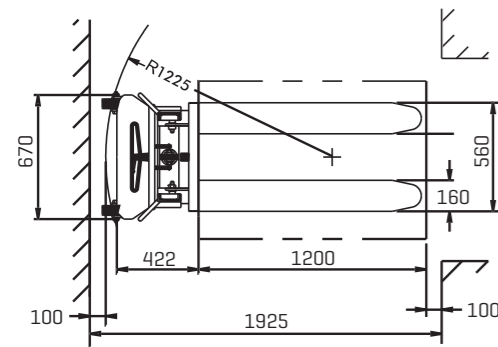

All dimensions in mm.  
 Materials and specifications are subject to change without notice

To know more about Maini's comprehensive solutions to simplify material handling and warehousing, write to me at [mtrlsmov@maini.com](mailto:mtrlsmov@maini.com)

**MAINI BRANCH OFFICES**

- NORTH REGION : Gurgaon
- SOUTH REGION : Bengaluru, Chennai
- WEST REGION : Mumbai, Pune, Ahmedabad, Vadodara

**PAN INDIA CHANNEL PARTNERS**

- Ahmedabad • Aurangabad • Bengaluru • Chandigarh • Chennai • Cochin
- Coimbatore • Faridabad • Ghaziabad • Goa • Gurgaon • Hosur • Hyderabad
- Indore • Jamshedpur • Kanpur • Kolhapur • Kolkata • Madurai • Mumbai
- Nagpur • Nashik • Noida • Pune • Satara • Vapi • Visakhapatnam

For enquiries please contact:

**MAINI MATERIALS MOVEMENT PVT. LTD.**  
 Sy. 32, Chandapura, Hosur Road, Bengaluru - 560 099, INDIA.  
 Phone: +91 80 4352 6555 Fax: +91 80 4352 6580

Visit us at: [www.mainimaterials.com](http://www.mainimaterials.com)

JANUARY 2016  
 Features and specifications subject to change.

MAINI  
 MATERIALS  
 MOVEMENT



Value delivered. Always

PV SERIES

SHP 10 SERIES

MS 10

SIMPLIFYING  
 MATERIAL HANDLING  
 & WAREHOUSING



# MANUAL RANGE

# MANUAL RANGE



## FEATURES



### EASY OPERATION

Entry / Exit rollers for effortless operation



### RESPONSIVE HYDRAULIC SYSTEM

The hydraulic pump is easy to operate and has an in-built automatic neutral position



### FIRM ANCHORING

Supporting clamps in front of the rollers to reduce risk of tipping over



### WEIGHING SCALE DISPLAY UNIT

Weight indication on the display can be pounds or kilogram



### ROBUST STABILITY

Side stabilizers ensure equipment remains stationary while used as worktable

## ENGINEERING EXCELLENCE

- Easy Maintenance** : 12 lubrication grease nipples on all movable parts for easy maintenance
- Enhanced Productivity** : Manual high lift offers efficiency and versatility
- Higher Safety** : Automatic activation of self adjusting stabilizers at loads higher than 400mm, for greater stability
- Easy Loading** : Loads can be easily placed at required ergonomic work height
- Operator Comfort** : An economical lift to handle tasks from transporting dies, moulds, skids & pallets. It allows the operator to work without having to perform extreme body movements.



**LOOK FOR THE EMBOSSED MAINI LOGO TO ENSURE GENUINE PRODUCT PURCHASE**

### TECHNICAL SPECIFICATIONS OF PV SERIES

| Lift per stroke | : 12 mm                         |        |        |
|-----------------|---------------------------------|--------|--------|
| Weight          | : 67 kg                         |        |        |
| Wheels          |                                 |        |        |
| Steer           | : Nylon (2) : 200 x 50mm        |        |        |
| Load tandem     | : Nylon (4) : 80 x 70mm         |        |        |
| Options         |                                 |        |        |
| Load wheels     | : Polyurethane / Steel          |        |        |
| Steer wheel     | : Polyurethane / Rubber / Steel |        |        |
| Standard Frames |                                 |        |        |
| Dim. A          | Dim. B                          | Dim. C | Dim. L |
| mm              | mm                              | mm     | mm     |
| 1150            | 520                             | 200    | 1510   |
| 1150            | 685                             | 365    | 1510   |

### TECHNICAL SPECIFICATIONS OF SHP10 SERIES

| Model                |             |
|----------------------|-------------|
| Capacity             | 1000 kg     |
| Total Lift height    | 810 mm      |
| Lowered fork height  | 85 mm       |
| Fork Length          | 1220 mm     |
| Width over the forks | 550 mm      |
| Height of handles    | 975 mm      |
| Steering wheel       | 200 X 50 mm |
| Fork wheel           | 74 X 50 mm  |
| Truck weight         | 112-115 kg  |

## HYDRAULIC HAND PALLET TRUCK | PV Series

The PV is light weight hand pallet truck with a steering angle of 210 degrees. Weighing only 67 kg, it offers an unmatched weight to capacity ratio. It is designed for easy maneuverability, particularly in confined areas.



Model : **PV20 EWS**

Capacity: **2000kg**

Electronic Weighing Scale  
Provided with an integrated weighing scale with printers as an option



Model : **PV25 SS/G**

Capacity: **2500kg**

Stainless Steel/Galvanised  
For use in damp and corrosive environments. Ideal for chemical, paper, leather, food processing industries and cold storage



Model : **PV12 PRV**

Capacity: **1200kg**

Paper Roll Version  
Useful for carrying cylindrical loads such as paper rolls and drums [750 mm -1200 mm diameter]

### CUSTOM MADE MODELS FOR SPECIAL APPLICATION

- Low profile version [35mm-52mm lowered fork height]
- Pallet truck for rough terrain application
- Special sizes to suit application

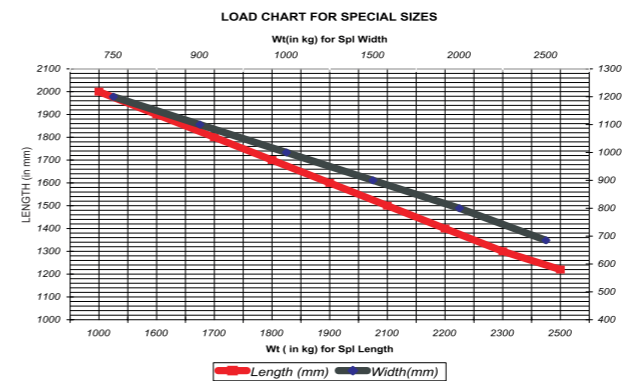

Important Note: For a combination of special length and special width, the lowest of the capacities mentioned are applicable. For example, for a fork length of 1400mm and fork width 600mm, the derated capacity is only 2000kg and not 2300kg

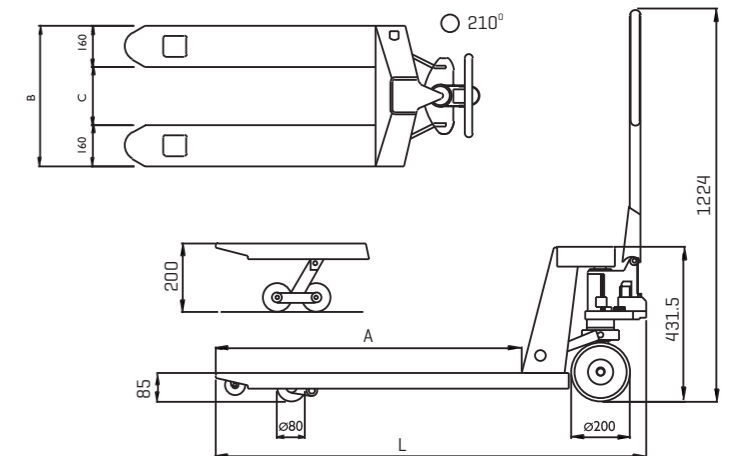

## SCISSOR HAND PALLET TRUCK | SHP 10 Series



SHP10



SHP10 B

The SHP combines the advantage of the hand pallet truck and the adjustable work table. The pallet can be positioned at the desired height while working. The SHP enables the operator to move the pallet truck upon completion of work.

A battery version is also available as SHP10 B.

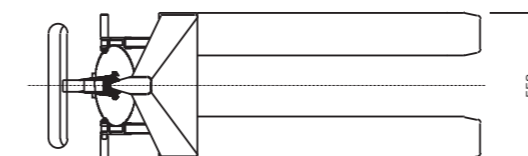

All dimensions in mm. Materials and specifications are subject to change without notice

